

# State Well Report

## Part 1 - Driller's Log

Mississippi Department of Environmental Quality  
Office of Land and Water Resources  
P.O. Box 10631  
Jackson, MS 39289-0631  
(601)961-5210  
(601)354-6938 (fax)

County: Desoto  
Permit #: \_\_\_\_\_  
Driller: Jones w. Mason  
Date drilling completed: 5-18-06

For Office Use Only:  
Aquifer: \_\_\_\_\_  
Well #: L-102  
L. S. Elevation: \_\_\_\_\_  
E-log #: \_\_\_\_\_

**State Law requires that this report be prepared by the license holder responsible for the work and filed with the Department at the above address within 30 days of completion of drilling of the well or borehole.**

| Information on Well Owner<br>(Landowner if borehole is not for a water well)   | Well or Borehole Location   |
|--|---|
| Owner Name: <u>Joe Frank Lauderdale</u>  | Latitude: <u>34° 46' 863"</u> Longitude: <u>89° 56' 102"</u>                              |
| Mailing Address: <u>5500 Getwell rd.</u>   | Method of Lat/Long (circle one): <u>52</u> Conventional Survey, <u>06</u>                 |
| <u>Herndon</u> <u>MS</u> <u>38632</u>  | USGS quad: <u>Hand-held GPS</u> Survey-grade GPS  |
| City State Zip Code  | <u>SW</u> $\frac{1}{4}$ <u>NW</u> $\frac{1}{4}$ Sec <u>34</u> Twn <u>35</u> Rng <u>76</u> |
| Telephone No. <u>(901) 494-2484</u>  | Distance <u>3.14</u> Miles Direction <u>NW</u> of Nearest Town <u>Alpha</u>               |
| <b>Well / Borehole Data</b>  |   |
| Date drilling started: <u>5-18-06</u> Date drilling completed: <u>5-18-06</u> Hole depth: <u>140'</u> Hole diameter: <u>8"</u>   |   |
| Location of the source of any surface water used for drilling: <u>NA</u>   |   |
| Method of dosing and volume of Chlorine used in drilling and development: <u>NA</u>  |   |
| Logs run (circle all applicable): <u>No log run</u> Electric Gamma Ray Density Sonic Neutron Other: _____  |   |
| Name of organization running log(s): <u>NA</u>   |   |
| Purpose of borehole (check one): Water Well <input type="checkbox"/> <input checked="" type="checkbox"/> Geotechnical/Geological Investigation <input type="checkbox"/> Ground Source Heat Pump <input type="checkbox"/>   |   |
| Seismic Survey <input type="checkbox"/> Other (describe) _____   |   |
| <b>If drilling is not related to water well construction, skip the remainder of this block</b>   |   |
| Purpose of Well (check one): Home <input type="checkbox"/> <input checked="" type="checkbox"/> Industrial <input type="checkbox"/> Public Supply <input type="checkbox"/> Irrigation <input type="checkbox"/> Fish Culture <input type="checkbox"/> Other: _____ |   |
| If a flowing well, method of flow regulation: Valve <input checked="" type="checkbox"/> <u>NA</u> Other (describe) _____   |   |
| Static Water Level: <u>26</u> feet above or below (circle one) land surface Date measured: <u>5-18-06</u>  |   |
| Method of Measurement (circle one) steel tape electric tape air line other: <u>string weight</u>   |   |
| Well depth: <u>140</u> Well grouted to a depth of <u>10</u> feet Type of grout (circle one): Neat Cement <u>Bentonite</u> Mix  |   |
| Casing length: <u>120</u> feet Casing diameter: <u>4</u> inches Type of casing: <u>pvc</u>   |   |
| Screen length: <u>20</u> feet Screen diameter: <u>4</u> inches Type of screen: <u>pvc</u>  |   |
| Screen slot size: <u>010</u> inches Setting depth: From <u>120</u> feet to <u>140</u> feet   |   |
| Type of completion (circle all applicable): <u>Gravel packed</u> Underreamed Telescoped Open hole Natural Development  |   |
| Other (describe): <u>NA</u>  |   |
| Top of lap pipe or reduction in casing: <u>NA</u> feet. <b>If telescoped or more than one screen, describe on next page</b>  |   |

Form: OLWR-SWR-1A

RECEIVED  
JUN 19 2006  
BY: OLWR

L-102

The sketch below only required for water wells

Description of formations encountered must be provided for all wells and boreholes, unless specifically exempted by regulations

If well telescopes, show depths on sketch.

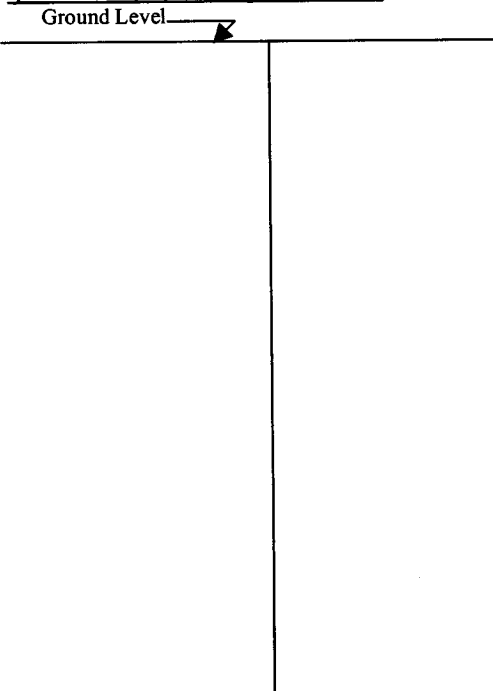

| Description of Formations Encountered | From (depth) | To (depth) |
|---------------------------------------|--------------|------------|
| clay dirt                             | Ground Level | 10         |
| white sand                            | 10           | 80         |
| Blue clay                             | 80           | 115        |
| white sand                            | 115          | 140        |
|                                       |              |            |
|                                       |              |            |
|                                       |              |            |
|                                       |              |            |
|                                       |              |            |
|                                       |              |            |
|                                       |              |            |
|                                       |              |            |
|                                       |              |            |
|                                       |              |            |
|                                       |              |            |
|                                       |              |            |
|                                       |              |            |

If more than one screen, show location of each on sketch

Sketch the property layout and include the following: 1) the well location; 2) any permanent structures on the property that may aid in locating the well; 3) any roads, power lines, or other items that may aid in locating the property and the well; 4) a north arrow.

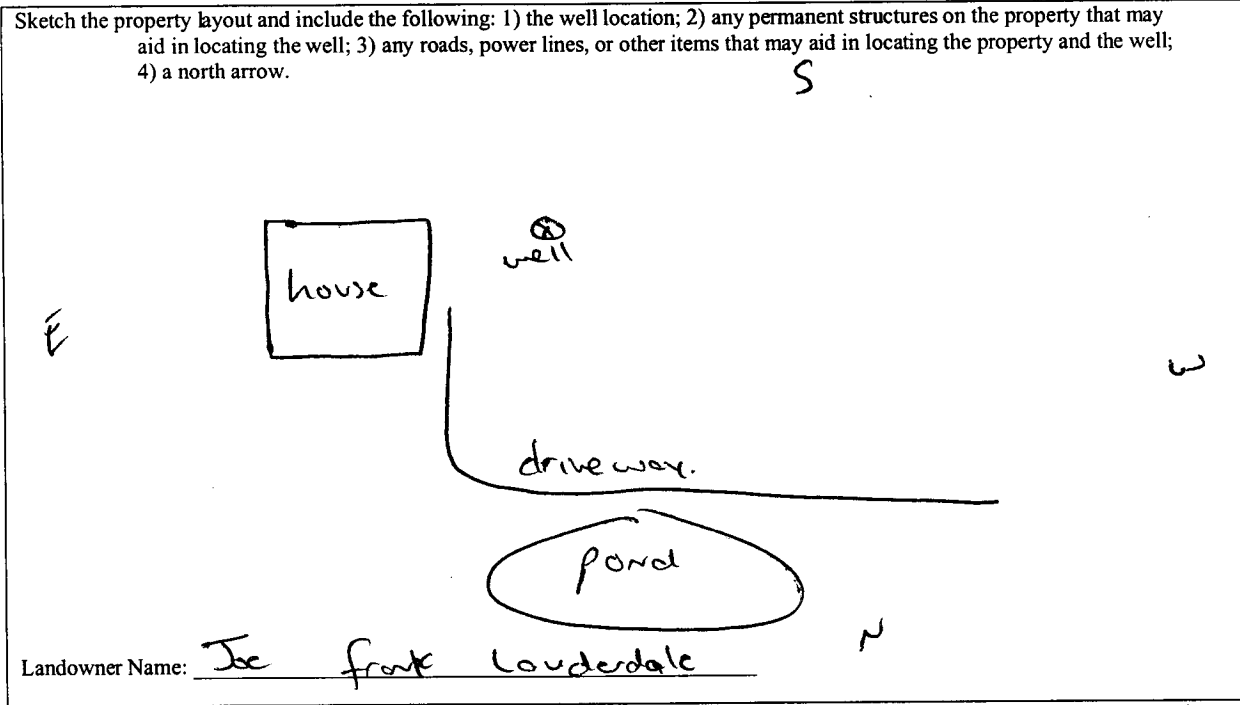

Form: OLWR-SWR-1A

I certify that the well/borehole was drilled, constructed, and completed in accordance with all applicable requirements of the Mississippi Department of Environmental Quality and the Mississippi Department of Health regulations, if applicable, and state laws.

Print Name of Responsible Licensee and License No. Jones W. Mason 2-620 Date 6-13-06

Signature of Licensee *Jones W. Mason*

RECEIVED

JUN 19 2006

BY: OLWR

# STATE WELL REPORT

## Part 2

**Pump Installer's Completion Report**  
 Mississippi Department of Environmental Quality  
 Office of Land and Water Resources  
 P.O. Box 10631  
 Jackson, MS 39289-0631  
 (601)961-5210  
 (601)354-6938 (fax)

County: Desoto  
 Permit #: \_\_\_\_\_  
 Driller: Jones w. Mason  
 Date completed: 5-18-06  
*Copy information from block on Part 1*

**For Office Use Only:**

Aquifer: \_\_\_\_\_  
 Well #: L-102  
 Elevation: \_\_\_\_\_

*This part of the report must be completed by a licensed water well contractor or a licensed pump installer. A copy of Part 1 of the report must be attached and both parts filed with the Department at the above address within 30 days of well completion.*

| Well Owner Information                  | Well Location  |
|---|--|
| Owner Name: <u>Joe Frank Lauderdale</u> | Latitude: <u>34.46863</u> Longitude: <u>89.56102</u>   |
| Mailing Address: <u>5500 Getwell</u>    | Method of Lat/Long (check one): Conventional Survey _____, USGS quad _____, Hand-held GPS <input checked="" type="checkbox"/> , Survey-grade GPS _____ |
| <u>Hernando</u> <u>ms</u> <u>38632</u>  | <u>SW</u> $\frac{1}{4}$ <u>NW</u> $\frac{1}{4}$ Sec <u>34</u> T <u>3s</u> R <u>7w</u>  |
| City State Zip Code                     | Distance Direction Nearest Town  |
| Telephone No. <u>(901) 494-2484</u>     | <u>3.14</u> Miles <u>NW</u> of <u>Alphabga</u>   |

| Pump Type<br>Circle one  | Power Type<br>Circle one   |
|--|--|
| Air Lift Jet <input type="checkbox"/> <b>Submersible</b> <input checked="" type="checkbox"/> | Diesel Engine Gasoline Engine Natural Gas  |
| Bucket Piston <input type="checkbox"/> Turbine <input type="checkbox"/>                      | <b>Electric Motor</b> <input checked="" type="checkbox"/> Hand <input type="checkbox"/> Tractor PTO <input type="checkbox"/> |
| Centrifugal Rotary <input type="checkbox"/> Flowing Well <input type="checkbox"/>            | Windmill Other (specify): _____  |
| Other (specify): _____   | Horse Power Rating of Motor: <u>1 1/2</u>  |
| Date Pump Installed: <u>5-18-06</u>  | Setting Depth: <u>60</u> feet  |
| Rated Pump Capacity: <u>20</u> Gallons Per Minute  | Number of Stages: <u>14</u>  |

| Pump Test Data   | Method of Measuring Water Level<br>Circle one   |
|--|---|
| Date Well Tested: <u>5-18-06</u>                           | Air Line Electric Measuring Line Steel Tape   |
| Static Water Level (A): <u>26</u> Feet Below Land Surface  | Other (specify): <u>string weight</u>   |
| Pumping Water Level (B): <u>NA</u> Feet Below Land Surface | For flowing well, measured shut in head: <u>NA</u> feet                                       |
| Drawdown [(B) - (A)]: <u>NA</u> Feet Below Land Surface    | Well yielded <u>20</u> GPM with a drawdown of <u>NA</u> feet after <u>24</u> hours of pumping |
| Test Pumping Rate: <u>20</u> Gallons Per Minute            |   |
| Duration of Pump Test (minimum 4 hours): <u>24</u> hours   |   |

I HEREBY CERTIFY that the above statements are true to the best of my knowledge.

Jones w. Mason  
 Print Name of Pump Installer and License No. (if applicable)

Jones w. Mason  
 Signature of Pump Installer

**RECEIVED**  
 Form: OLWR-SWR-1B

JUN 19 2006  
 BY: OLWR